

: Torque, N·m (lbf·ft) : Replace : Warning/Caution : Inspection/Adjustment : Learning : SPL Tool : Required Removal

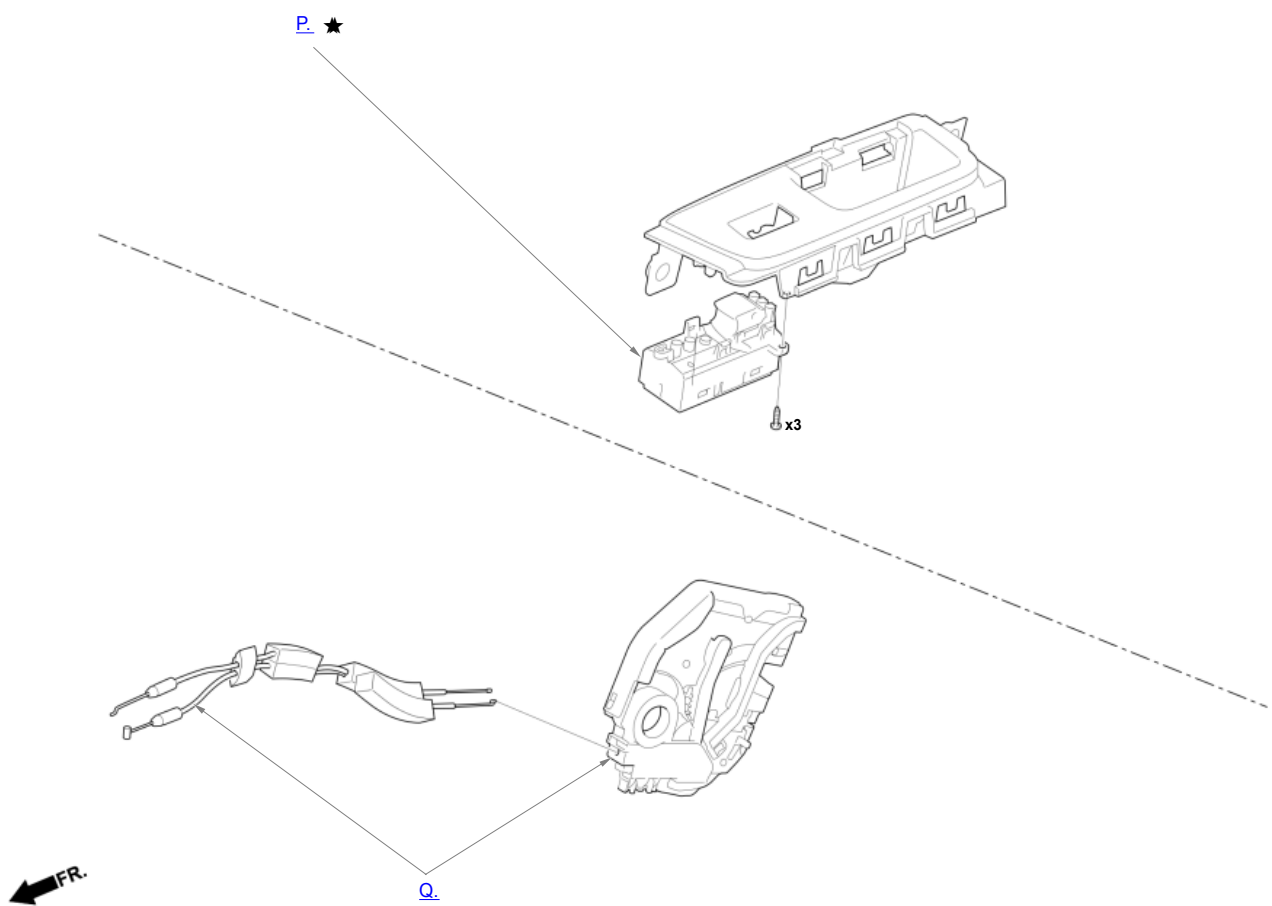

 Torque, N·m (lbf·ft)
 ✕ Replace
 ⚠ Warning/Caution
 ● Inspection/Adjustment
 ★ Learning
 ■ SPL Tool
 - - - - - Required Removal

A. -

■ Sub-Procedure

- **Removal**

- Refer to the figure.

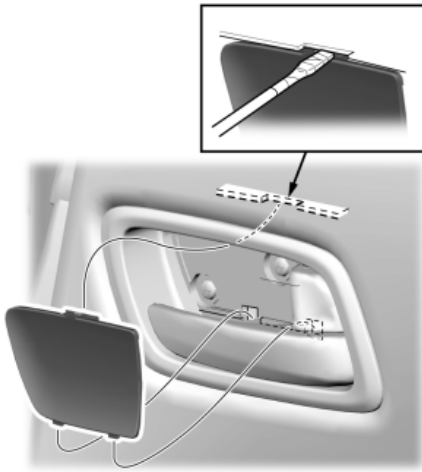

B. -

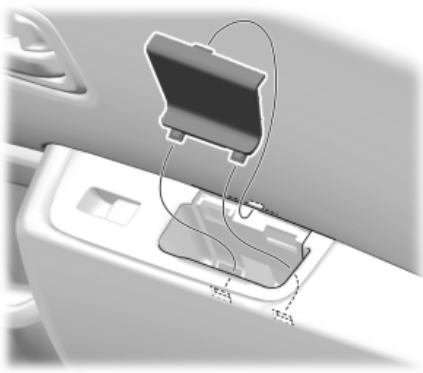

C. -

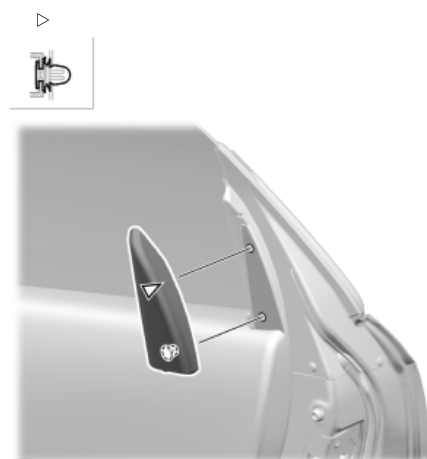

D. -

■ Sub-Procedure

● Removal

* Refer to the figure.

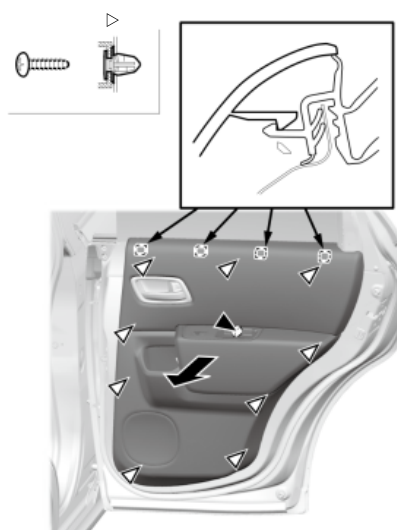

E. -

NOTE: Take care not to bend the cables.

■ **Sub-Procedure**

● **Removal**

- Refer to the figure.

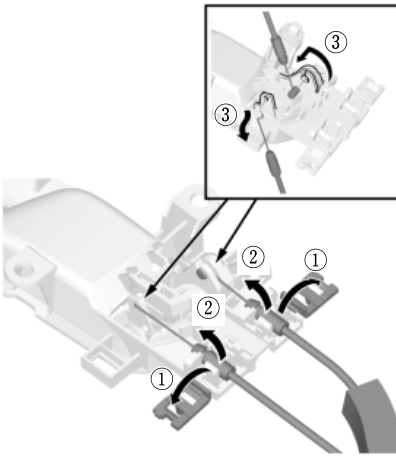

F. -

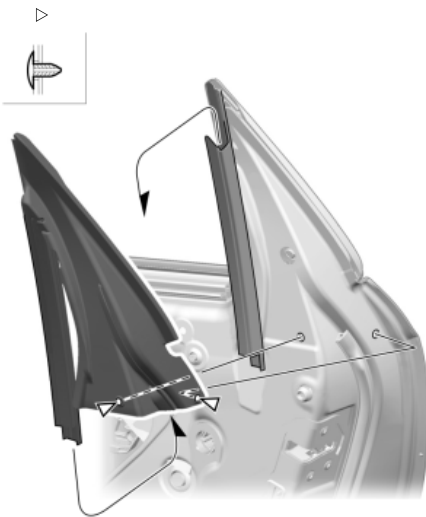

G. -

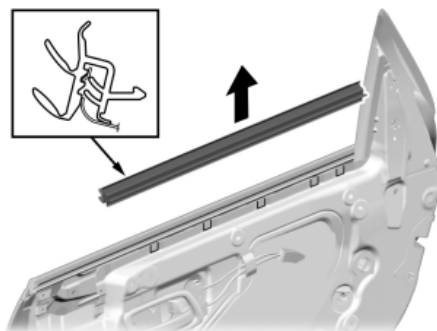
**■ Sub-Procedure****• Removal**

- Refer to the figure.

H. -

■ Sub-Procedure**• Installation**

NOTE: If the rear door plastic cover is damaged or torn, replace it with a new one.

I. -

■ Sub-Procedure

- **Removal**

- Refer to the figure.

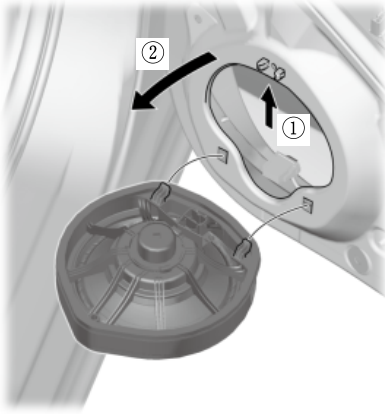

J. -

- **After Installation**

- [Rear Door Position Adjustment](#)

K. -

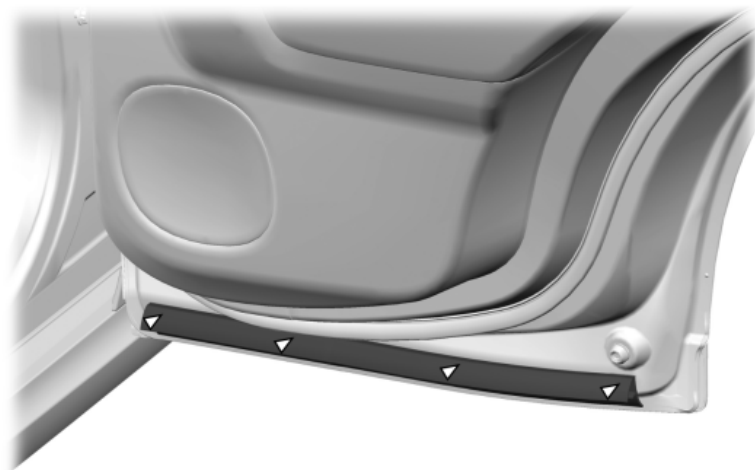
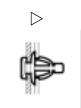

L. -

■ Sub-Procedure

● Removal

1. Remove the rear door plastic cover as needed.
2. Pull the rear door latch (a) downward to disconnect the rear door outer handle rod (b), and then remove the rear door latch.
(Figure 1)

Figure 1

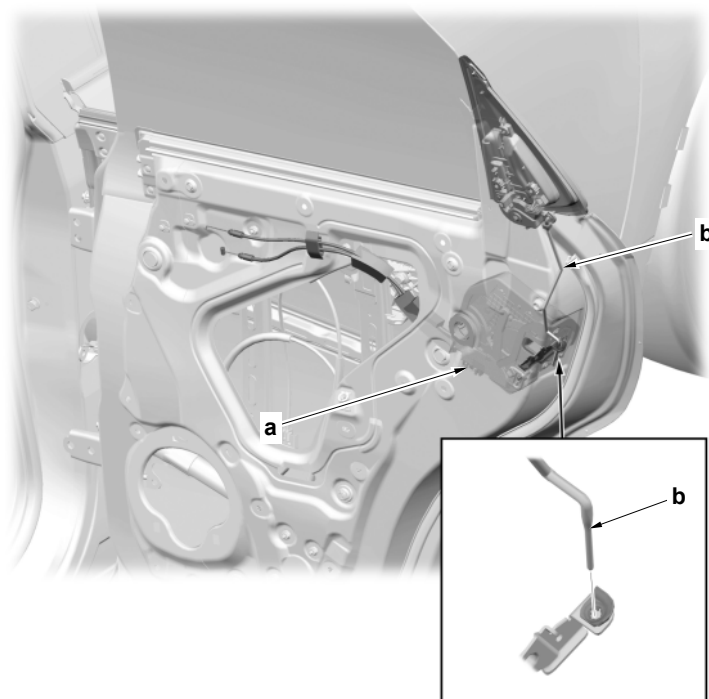

- **Installation**

NOTE: Apply multipurpose grease (c) to the open lever clip (d) as shown. (Figure 2)

Lubricant Specifications (Figure 2)

Position	Type
d	Multipurpose Grease

Figure 2

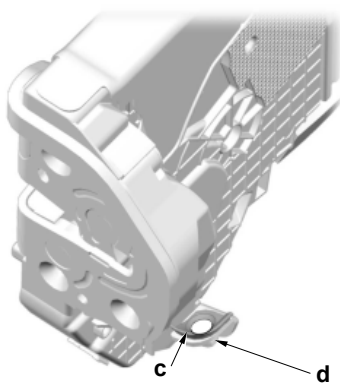

M. -

■ Preconditions

- [Power Window Operated](#)

■ Sub-Procedure

• Removal

NOTICE

- Take care not to drop the rear door glass inside the door.
- Do not close the door before removing the rear door glass.

- Refer to the figure.

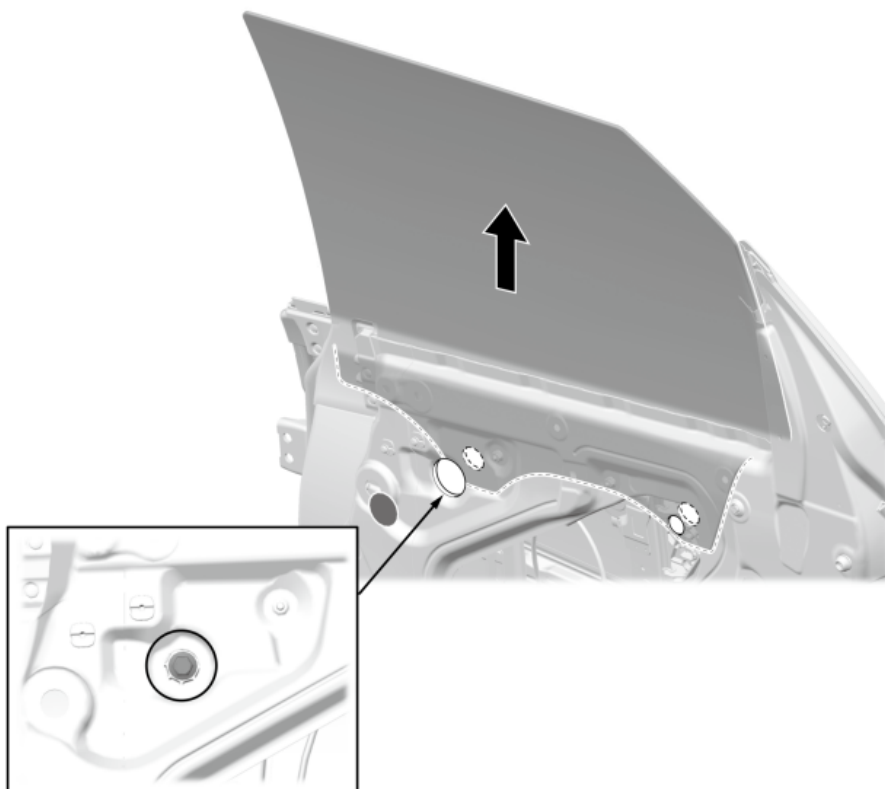

■ After Installation

1. [Rear Door Glass Adjustment](#)
2. [Power Window Control Unit Reset](#)

N. -

■ Sub-Procedure

● Installation

NOTE: Apply multipurpose grease (a) to all sliding surfaces.

Lubricant Specifications

Position	Type
b	Multipurpose Grease

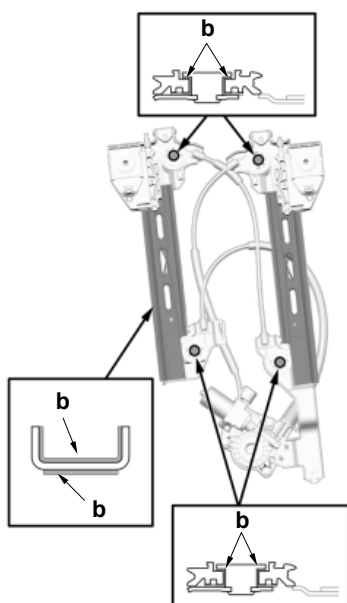

■ After Installation

1. [Rear Door Glass Adjustment](#)
2. [Power Window Control Unit Reset](#)

O. -

■ Sub-Procedure**● Removal**

- * Refer to the figure.

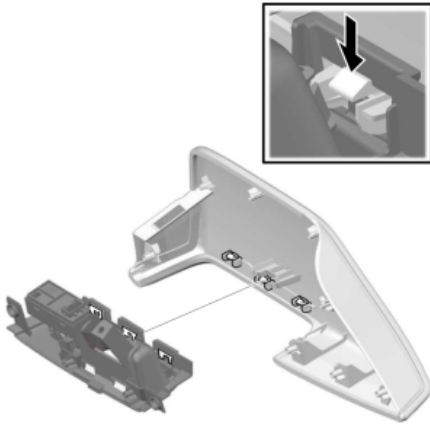

P. -

NOTE: If the power window switch is replaced, [reset the power window control unit](#). If the original power window switch is installed, confirm that the power window works properly.

■ After Installation

- [Power Window Control Unit Reset](#)

Q. -

NOTE: Take care not to bend the cables.

■ Sub-Procedure

• Removal

- Refer to the figure.

